

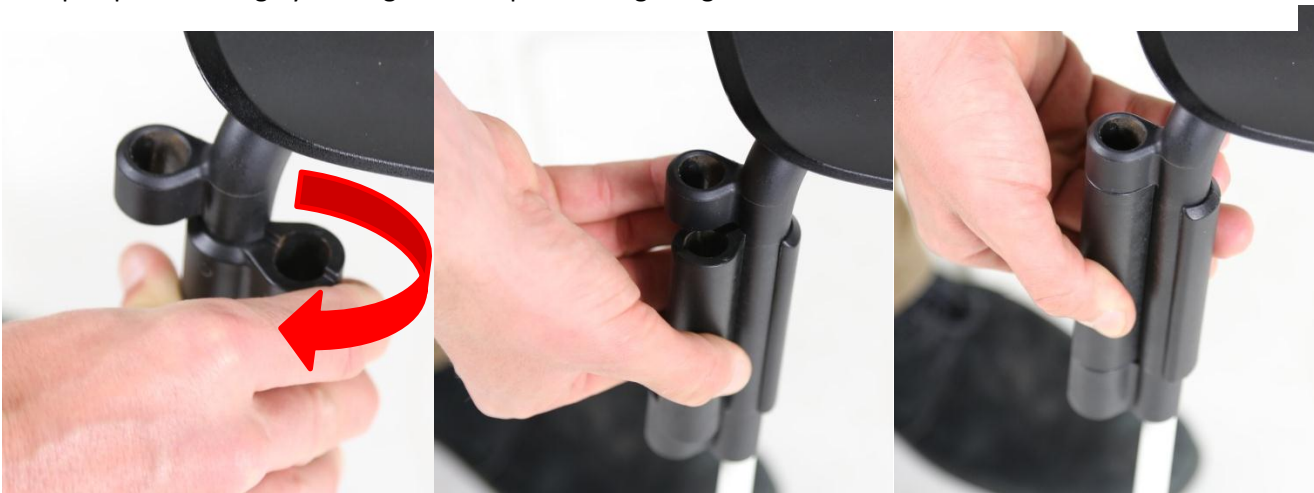

**Installation instruction** – Please scan QR code for the video instruction



1. Open plastic fitting by turning lock and place on right leg of chair.



2. Close plastic fitting by turning lock.



4. The steel fitting is mounted into the plastic fitting.

# INNO<sup>®</sup> NOTE

Four Sure 88 + Four Cast'2 Line



# FOUR<sup>®</sup>

D E S I G N



The tablet can be folded away



The tablet has an integrated cup holder